

ITEM NO.	PART NUMBER	QTY
1	I-42-EPF-Cap	1
2	I-42-EPF-L	1
3	I-42-EPF-T	1
4	I-42-EPF-Tube	1

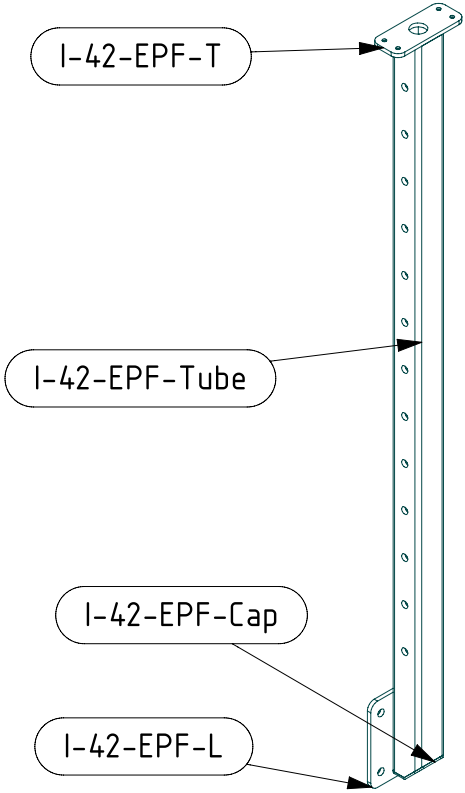

SCALE 1:10

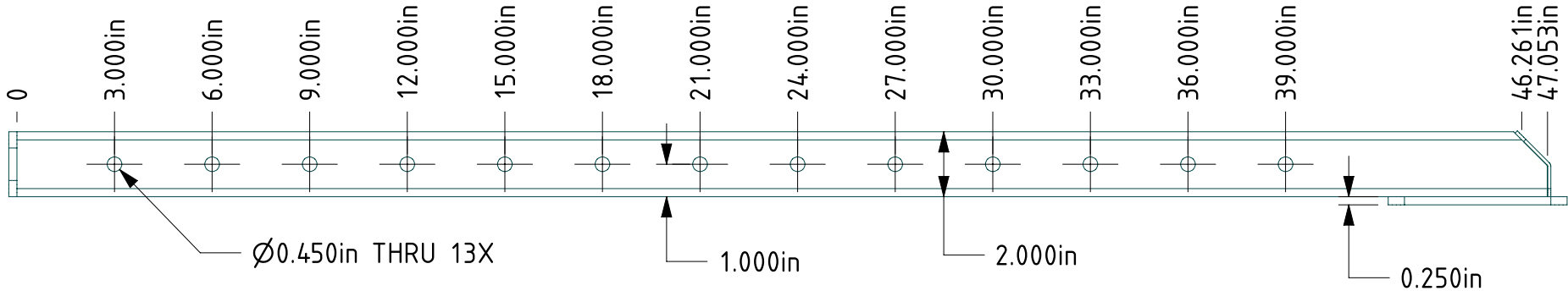
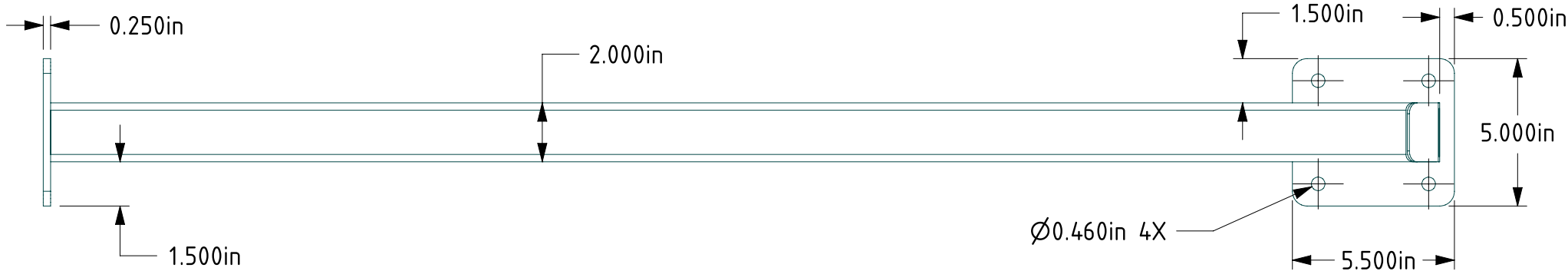
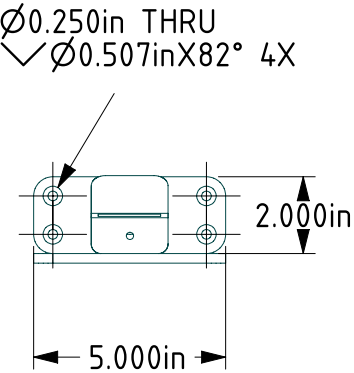

NOTES:  
 STANDARD MATERIAL & FINISH:  
 - A-36 STEEL POWDER COATED

ADDITIONAL MATERIAL OPTIONS:  
 - A-36 STEEL GALVINIZED  
 - TYPE 304 STAINLESS STEEL  
 - TYPE 316 STAINLESS STEEL

PROJECT: I-42-EPF		MATERIAL: SEE NOTE	
PART: I-42-EPF		FINISH: SEE NOTE	
DRAWN BY: JT		COLOR:	
DATE: 12/8/14		LOCATION:	
REVISION:		QUANTITY:	
SHEET: 1		OF: 1	

KEUKA

STUDIOS

FINE ARCHITECTURAL METAL WORK

1011 Rush Henrietta Townline Road  
Rush, NY 14543  
P 1-855-454-5678  
F 585-487-6150  
[www.keuka-studios.com](http://www.keuka-studios.com)