

ITEM NO.	PART NUMBER	QTY
1	K-42-IPS-B	1
2	K-42-IPS-L	1
3	K-42-IPS-S	1
4	K-42-IPS-T	1

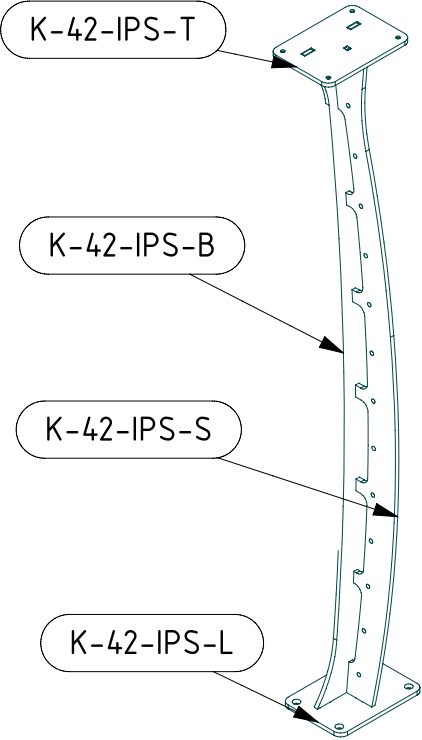

SCALE 1:10

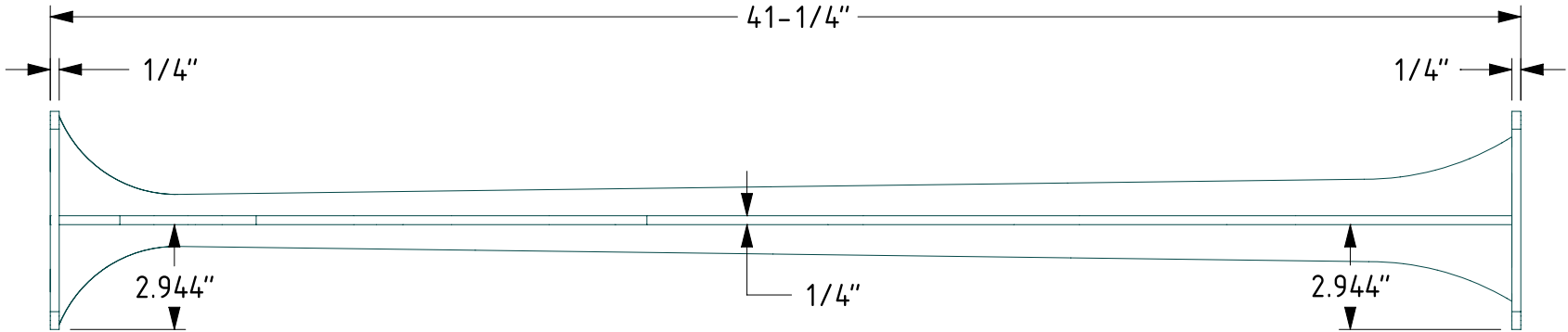
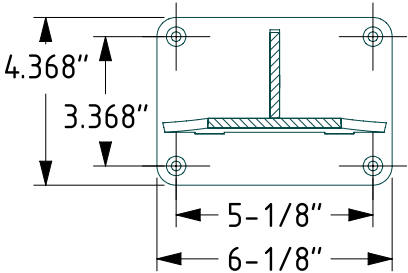

SECTION A-A

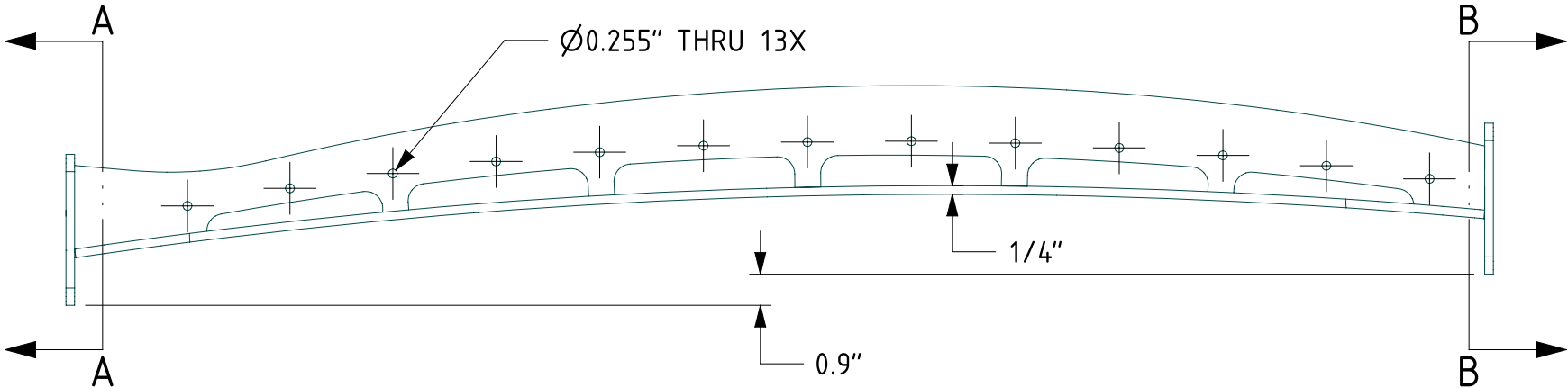

SECTION B-B

NOTES:
STANDARD MATERIAL & FINISH:
- A-36 STEEL POWDER COATED

ADDITIONAL MATERIAL OPTIONS:
- A-36 STEEL GALVINIZED
- TYPE 304 STAINLESS STEEL
- TYPE 316 STAINLESS STEEL

PROJECT: K-42-IPS		<div><div><div>KEUKA</div><div>STUDIOS</div></div><div>FINE ARCHITECTURAL METAL WORK</div></div> <div>1011 Rush Henrietta Townline Road RUSH NY 14543 P 585-454-5678 F 585-467-6130 www.keuka-studios.com</div>
PART: K-42-IPS		
DRAWN BY:		
DATE: 12/5/14	SCALE: 1:5	
SHEET: 1	REVISION:	SIZE: B
OF: 1		

KEUKA

STUDIOS

FINE ARCHITECTURAL METAL WORK

1011 Rush Henrietta Townline Road
Rush, NY 14543
P 1-856-454-5678
F 585-487-6150

www.keuka-studios.com

COPYRIGHT © 2014 BY KEUKA STUDIOS INC. ALL RIGHTS RESERVED. THESE DOCUMENTS ARE THE PROPERTY OF KEUKA STUDIOS INC. NO DISTRIBUTION IS PERMITTED WITHOUT WRITTEN APPROVAL FROM KEUKA STUDIOS INC.